

5x5 mm

sta

SYSTEM TO ASIC



Package Specifications:

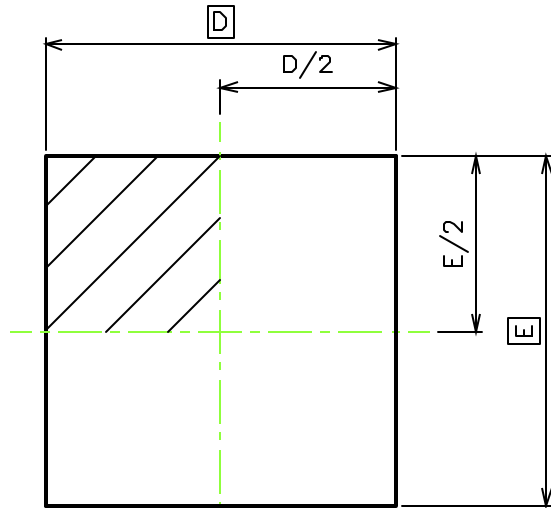

TOP VIEW

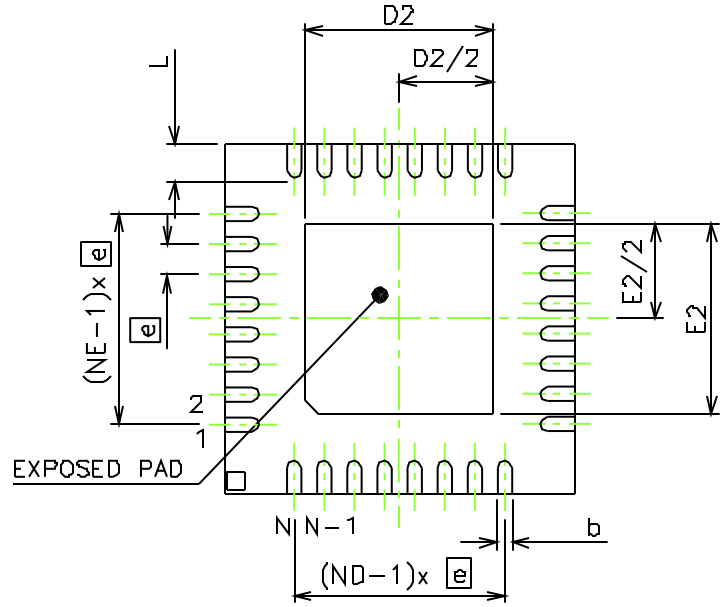

BOTTOM VIEW

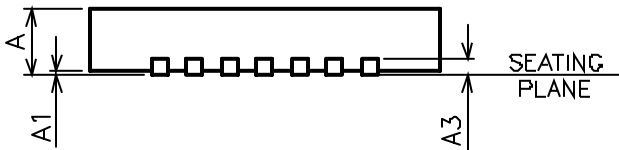

SIDE VIEW

32 Lead 5x5 mm

Symbol	Dimensions in Millimeters			Note
	Min	Nom	Max	
A	0.80	0.90	1.00	Package Height
A1	0.00	0.02	0.05	Ref Plane to Package
A3		0.20 Ref		Lead Height
b	0.18	0.25	0.30	Lead Width
D		5.00 BSC		Package Width
D2	3.10	3.20	3.30	Exposed Pad
E		5.00 BSC		Package Length
E2	3.10	3.20	3.30	Exposed Pad
e		0.50 BSC		Lead Pitch
L	0.45	0.50	0.55	Lead Length
N		32		Lead Count

Confidential and Proprietary Information